

## APPLICATION FOR A STANDARD CROSSOVER ON SHIRE ROADS

*This application must be submitted and approved before construction can commence.*

CROSSOVER DETAILS			
Applicant/s Name:			
Postal Address:			
Lot No:	Street No:	Street Name:	
Locality:	Postcode:		
Phone No:	Mobile No:		
Email Address:			
Is this a condition of planning consent or subdivision approval? (If Yes, Planning Officer will need to provide prior approval)			<input type="checkbox"/> Yes <input type="checkbox"/> No
Crossover Location	Applicants must complete the attached site plan showing the positioning and dimensions of the crossover, a sample is provided to assist.		
Type of Construction			
Concrete	Compacted Gravel	Brick Paving	Other ( <i>Please Specify</i> )
<input type="checkbox"/>	<input type="checkbox"/>	<input type="checkbox"/>	
Pipe Details (pipe diameter and headwall specifications)			
<b>Prior to commencement of any work, the Shire's nominated officer will inspect the site and provide written approval or requirement for alteration to the location or design</b>			

CROSSOVER SUBSIDY
<p>The Shire of York will only provide a subsidy for crossovers installed on road verges under Shire control. Only one crossover subsidy will be paid to each separate rate assessment. Any portion of a crossover in excess of the standards is not subsidised by Shire.</p> <p><b>Crossover Type and available subsidy:</b>  <b>Piped</b> - 50% of cost to a maximum of \$1,040.  <b>Gravel</b> - 50% of cost to a maximum of \$575.</p> <p>Payment of the subsidy will not be made until the work is complete and has been inspected and authorised by the nominated Shire officer.  <i>NO SUBSIDY IS APPLICABLE TO SUBDIVISIONS, AMALGAMATIONS OR BOUNDARY REALIGNMENTS – please contact the Shire of York Planner.</i></p>

CONDITIONS			
<ul style="list-style-type: none"> <li>• I hereby accept the conditions as set out in the Shire of York Policy relating to Crossovers.</li> <li>• I have not previously made application to the Shire of York for a crossover subsidy on this land.</li> <li>• I will provide written confirmation from my contractor that the works have been completed in accordance with the approval and provide a receipt for labour/materials for any applicable subsidy.</li> </ul>			
Signature:		Date:	

# SITE PLAN

1. Show road, house and lot numbers, north point, location of power poles, fences, buildings etc.
  2. Show dimensions and distance to clearly identify the position of the crossover.
- 

OFFICE USE ONLY			
Condition of Subdivision/amalgamation or boundary realignment?		<input type="checkbox"/> YES <input type="checkbox"/> NO	
Existing residence or development?		<input type="checkbox"/> YES <input type="checkbox"/> NO	
Existing Crossover on lot?		<input type="checkbox"/> YES <input type="checkbox"/> NO	
Is the property part of York Estates?		<input type="checkbox"/> YES <input type="checkbox"/> NO	
Site Inspected By:		Date:	
Completed Crossover Inspected By:		Date:	
Approved for Subsidy	<input type="checkbox"/> YES <input type="checkbox"/> NO	Signature:	

# SAMPLE SITE PLAN

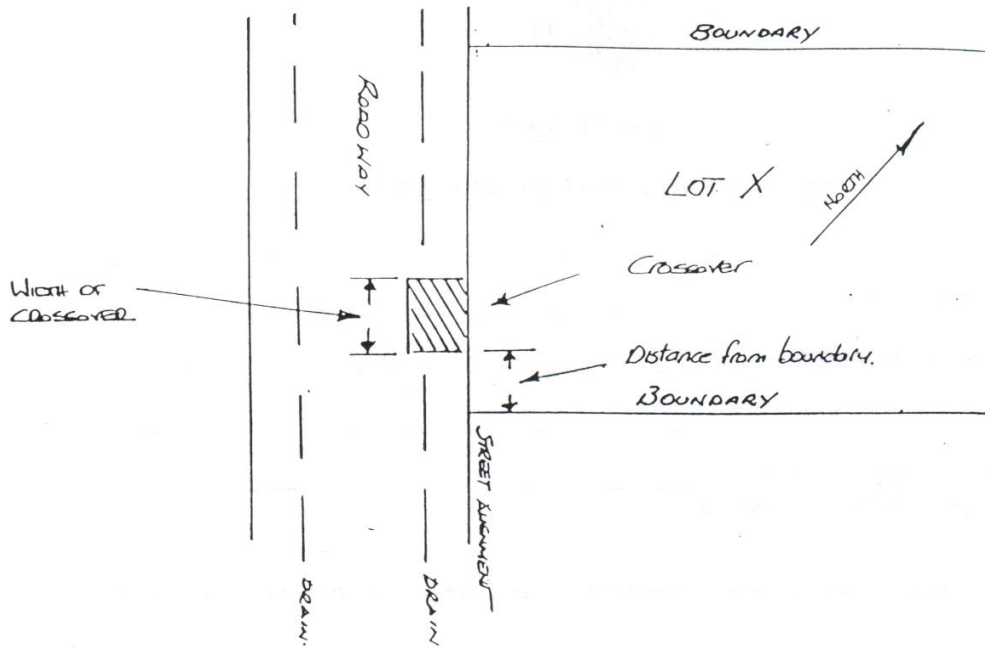

# HEADWALL CONSTRUCTION

