

SHIRE OF YORK

APPLICATION FOR A STANDARD CROSSOVER ON SHIRE ROADS

STEP 1. APPLICATION – Landholder to complete (also page 3)

Name		
Postal address		
Property address		
Contact phone		Mobile
Is this a condition of planning consent or subdivision approval? (If Yes, Planning Officer will need to approve prior to Works Department)		Yes / No
I have not previously made application to the Council for a crossover subsidy on this land.		
Signature		Date

STEP 2. APPROVAL – by Works Supervisor prior to commencement

Site inspection	Pipe size required	Date
Comments / amendments		
Signature		Date

STEP 3. CROSSOVER – Works by Contractor

STEP 4. COMPLETION – Certification by Contractor

Name		
Postal address		
Contact phone		Mobile
Work has been completed as per specification and location plan.		
Signature		Date

STEP 5. PAYMENT – Authorisation by Works Supervisor

Final inspection	Approved	YES / NO
Comments		
Signature		Date

SHIRE OF YORK

SAMPLE LOCATION PLAN

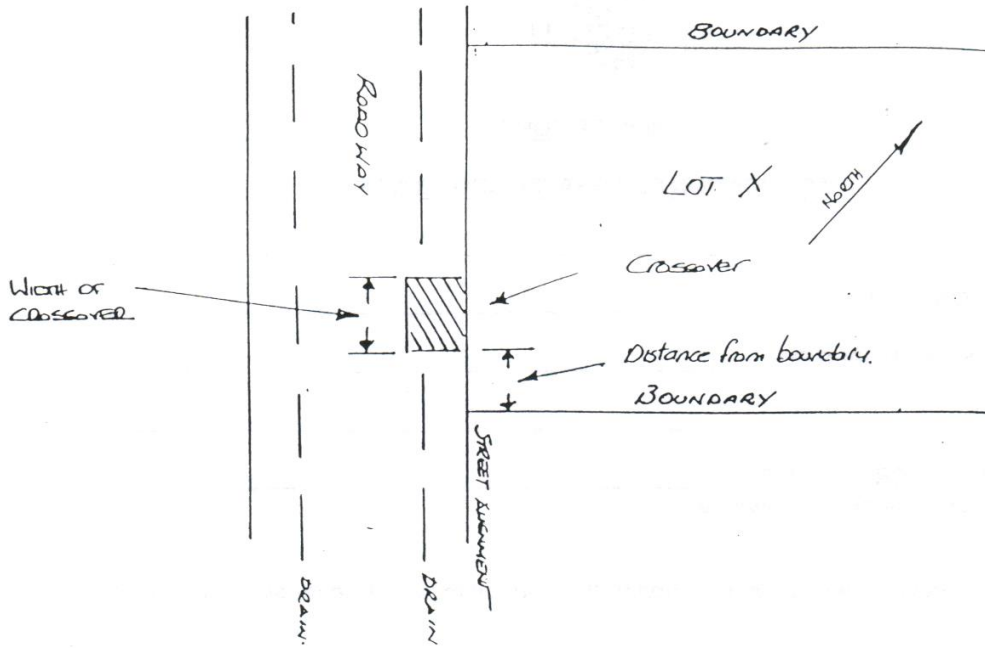

HEADWALLS CONSTRUCTION

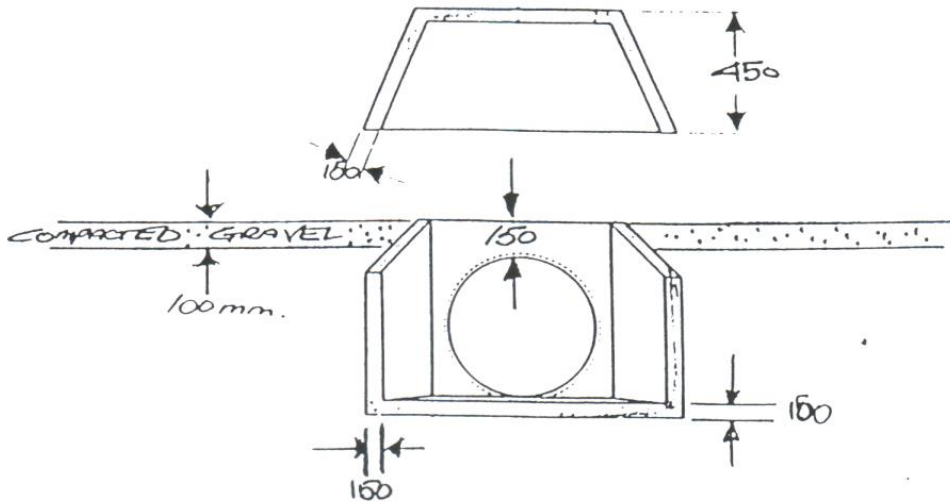

LOCATION PLAN

1. Show road, house and lot numbers, north point, location of power poles, fences, buildings etc.
 2. Show dimensions and distance to clearly identify the position of the crossover.
-

SHIRE OF YORK
SPECIFICATIONS FOR STANDARD CROSSOVER CONSTRUCTION

1. Council will provide a subsidy only on roads under Council control. Crossovers on the following are under the control of Main Roads WA and application should be made direct to them. MRWA contact details: (08) 9323 4111 or enquiries@mainroads.wa.gov.au.
 - a. York - Quairading Road
 - b. Northam - York Road
 - c. Great Southern Highway & Northam Cranbrook Road
 - d. York – Perth Road
 - e. Balladong Street
 - f. Henrietta Street
 - g. Panmure Road
2. Only one crossover subsidy will be paid to each separate rate assessment.
3. Prior to constructing any crossover within a road reserve, an application for a crossover showing the proposed location and other details is required.
4. Prior to commencement of any work, Council's Works Supervisor will inspect the site and provide written approval or requirement for alteration to the location or design. The approval will specify the size of pipe, if required.
5. Crossovers are to be constructed to the following specifications –
 - a. Crossovers shall not be less than 3 metres in width to a maximum width of 6 metres.
 - b. The crossover area shall be boxed out to a minimum depth of 100 mm from the pavement to the boundary, and graveled.
 - c. The gravel fill is to be graded and compacted to the satisfaction of the Works Supervisor.
 - d. The crossover is to be constructed so as to have an even fall, avoiding any hump at any pipe installed.
 - e. Approved crossover finishing materials are concrete, bitumen and brick paving for all residential crossovers in accordance with the R-Codes.
6. Where pipes are required –
 - a. The pipes are to be installed so that they have a minimum of 150 mm compacted gravel cover.
 - b. Concrete headwalls shall have a minimum thickness of 150 mm concrete (20MPA), and must extend at least 150 mm above the pipe
 - c. A concrete apron shall be constructed with a minimum thickness of 100 mm and shall extend at least 450 mm from the end of the pipe which is standard of a pre cast headwall.
 - d. Concrete wing walls at least 150 mm thick shall extend from the pipe to the end of the apron standard of a pre cast headwall.
7. Crossover subsidy will be paid as follows –

Standard crossover is 4.8 metres wide, piped with concrete headwalls as necessary, graveled and compacted and finished with concrete, bitumen or brick paving.
The portion of a crossover in excess of the standards is not subsidised by Council.
Subsidy is not applicable on MRWA verges.

NO SUBSIDY IS APPLICABLE TO SUBDIVISIONS, AMALGAMATIONS OR BOUNDARY REALIGNMENTS.

Crossover Installation – Pipes
Shire subsidy if installed by owner (50% of cost to a maximum of \$1,040)

Crossover Installation – Gravel
Shire subsidy if installed by owner (50% of cost to a maximum of \$575)
8. Work in excess of that specified above is fully at the landowner's cost, and will not be subsidised by Council.
9. Payment of the subsidy will not be made until the work is complete, and has been inspected and is authorised by the Works Supervisor.

10. Procedure for bonding crossover works for subdivision clearance.

Bonding the crossover works for the purpose of subdivision clearance is calculated as follows;

- Total cost of works
- Plus 20% contingency
- Plus 10% GST

Applicants are still required to complete the works in a time specified by the Shire of York.

Once the works are completed to the satisfaction of the Shire of York, the bond will be refunded. If the work is not completed in the specified time, Council may choose to complete the works using the funds from the bond. Council reserves the right to release the bond until such time that the works are completed to their satisfaction.

Please be advised that Council will not accept a bond for crossover works on roads that are controlled by Main Roads WA (see point 1).