

Proposed location of garage.



Two sheds at rear - Machinery & Hay Sheds.



Front of property.



Carries with view of caravan shed behind.

Mr Paul Wheeler

125 North Road

York Wa 6302

21/09/2015

TO WHOM IT MAY CONCERN

I Paul wheeler I am writing this justification letter to explain why I would like to put this new shed up.

And this reason being is that this new shed is to house our boat and my wife's car as we have machinery for cropping etc, and cars and a caravan that already are in the previous sheds we have.

Yours sincerely



Paul Colin Wheeler

* AM AVAIRIES

MR PAUL CONN WHEELER
125 NORTH RD
YORK MA 03002.

POSTAL ADDRESS:
P.O Box 603
YORK MA 0302
MOB: 0417 139837

1 CRANK FENCE

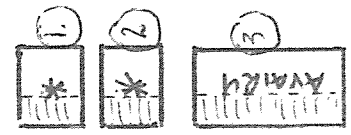
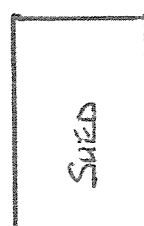
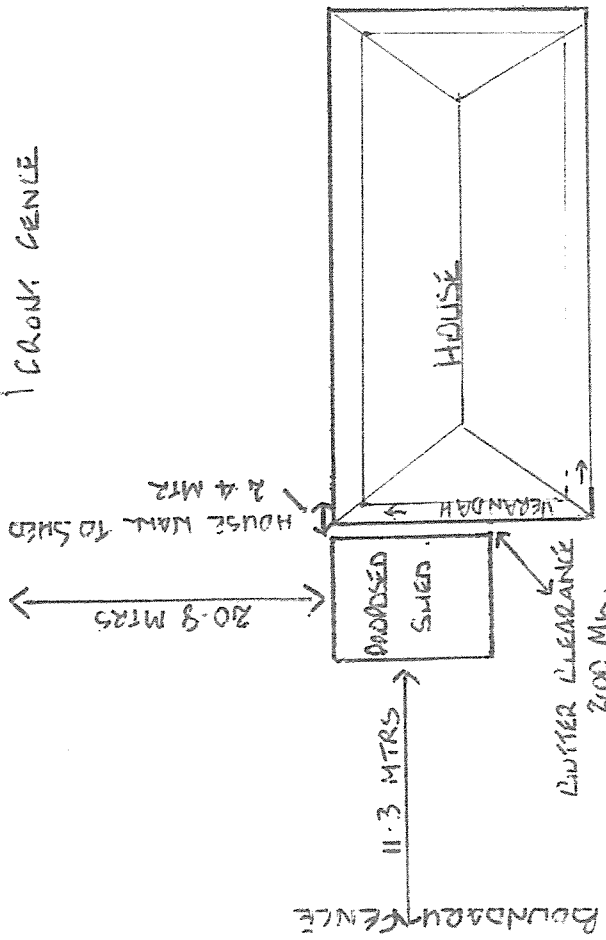

- ① L. 4.0 MTR x W 2.4 MTR x H 2.2 MTR
- ② L. 3.1 MTR x W 3.0 MTR x H 2.2 MTR
- ③ L. 3.0 MTR x W 8.0 MTR x H 2.4 MTR
- ④ L. 5.7 MTR x W 3.65 MTR x H 2.25 MTR
- ⑤ L. 3.1 MTR x W 2.75 MTR x H 2.2 MTR
- ⑥ L. 4.1 MTR x W 7.85 MTR x H 2.4 MTR
- ⑦ L. 2.35 MTR x W 8.15 MTR x H 2.4 MTR
- ⑧ L. 2.35 MTR x W 8.65 MTR x H 2.2 MTR
- ⑨ L. 3.8 MTR x W 1.35 MTR x H 2.2 MTR
- ⑩ L. 8.0 MTR x W 3.9 MTR x H 3.3 MTR

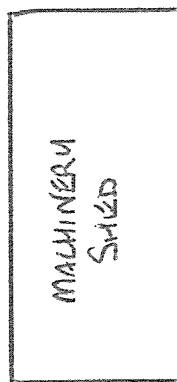
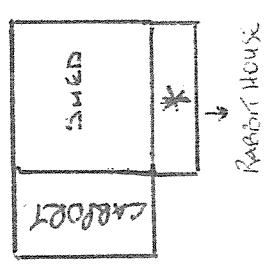
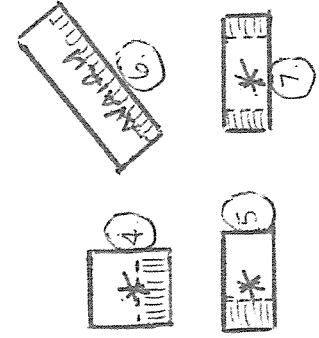

NO'S CORRESPOND WITH
AVAIRY NO'S.

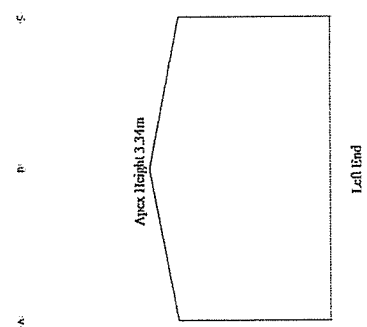
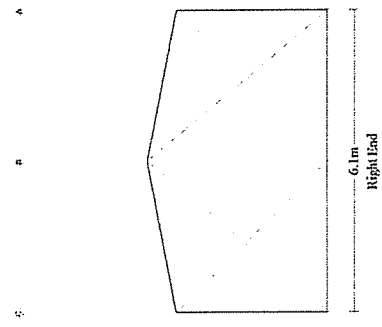
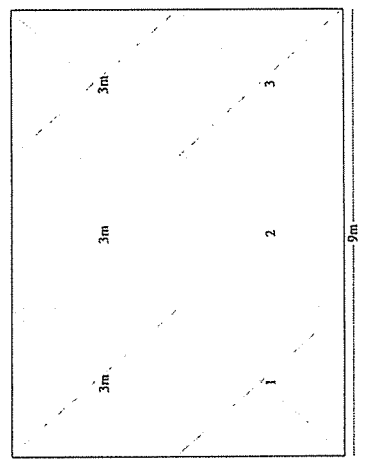
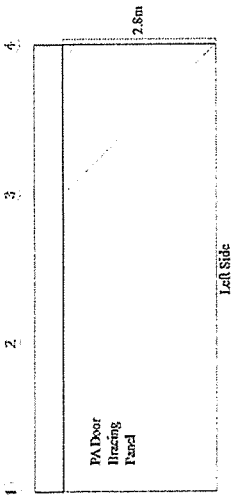

Purchaser Name: Paul Wheeler

Site Address: 125 North Road YORK WA Australia 6302

Drawing # TMJN150160 - 5

Print Date: 21/08/15

Bracing

Seller: THE Shed Company Murchison
 DT Edwards & TG Edwards
 Phone: (09) 5594 5020
 Fax: (09) 5595 0725
 Email: murchison@theshedcompany.com.au

SHOWERS ENGINEERING PTY LTD
 ACN: 075 007 144
 ME Aust. (Registered NFER Structural & Civil) 221787
 QLD: FR 0046, 1591, VIC: EC24182, 195, CC04001, NT: 46926ES,
 Practising Professional Structural & Civil Engineer

Signature: 

R.J. Showers Date: 21/08/15

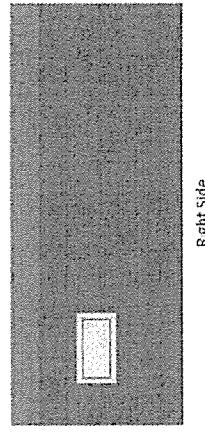
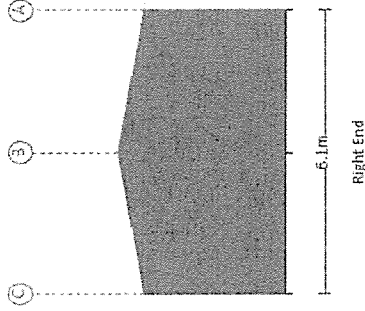
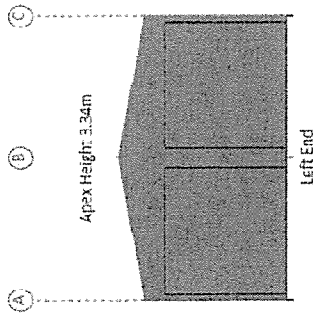
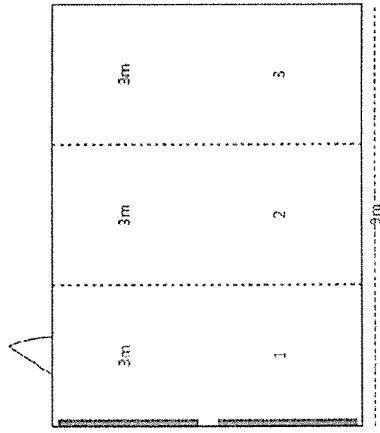
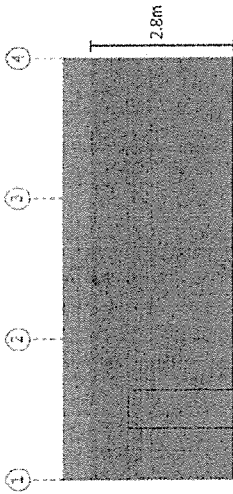

Purchaser Name: Paul Wheeler

Site Address: 125 North Road YOCKYON WA Australia 6302

Drawing / TM/DN/150160 - 3

Layout

Seller: THE Shed Company Manufacturing
 DT Edwards & TG Edwards
 Phone: (08) 9394 5200
 Fax: (08) 9329 0725
 Email: manufacturing@theshedcompany.com.au

SHOWERS ENGINEERING PTY.LTD
 ACN: 075 007 144
 ME/Asst. (Registered NPER Structural & Civil) 321787
 P.L.D.: RPEO No. 1547; VC: EC24162; V/S: CC46001 (N.T. -46268ES;
 Preceding Professional Structural & Civil Engineer

Signature: 
 Signature: R.J. Showers Date: 21/08/15