

* ALL AVAIRIES

MR PAUL LOUW WHEELER
125 NORTH RD
YORK WA 6302.

POSTAL ADDRESS:
P.O Box 603
YORK WA 6302
MOB: 0417 139837

WORK YENIK

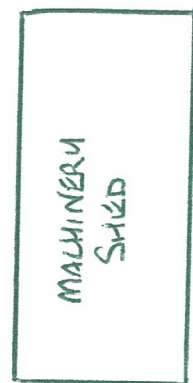
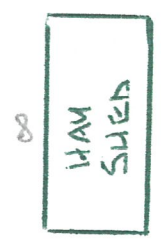
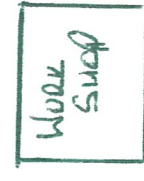
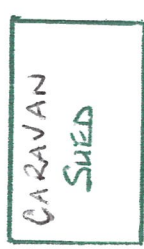
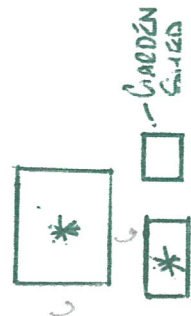
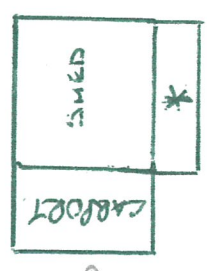
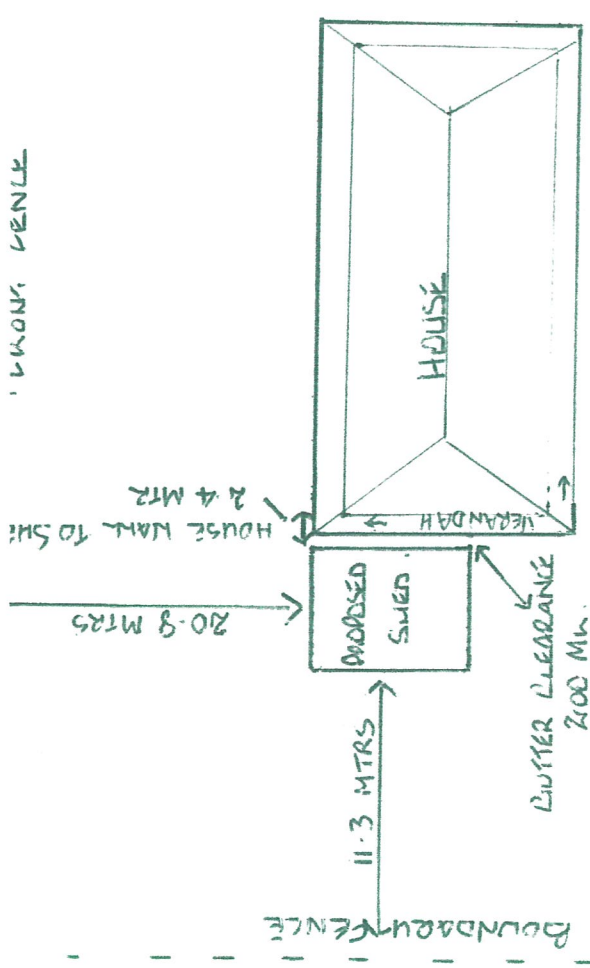

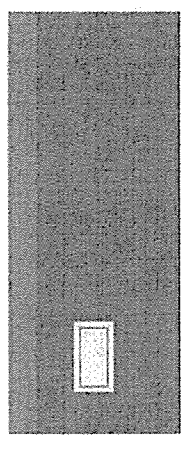
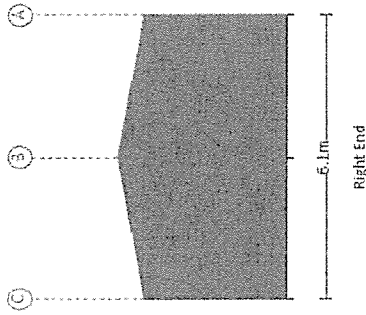
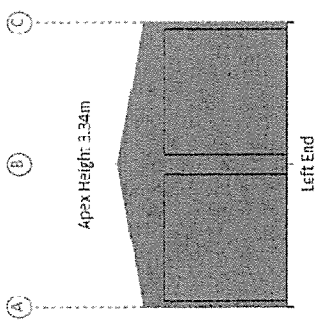
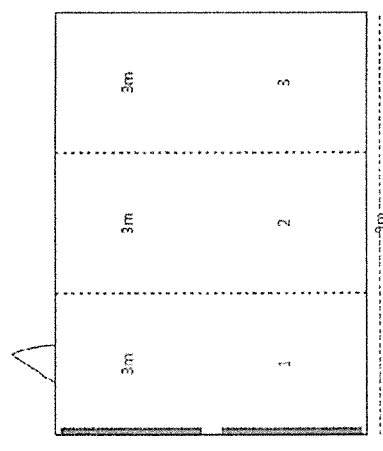
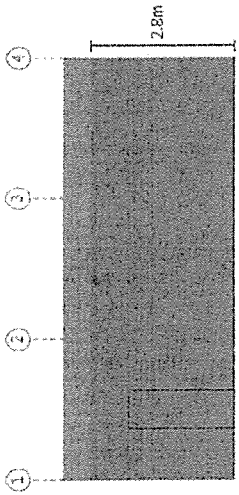

Purchaser Name: Paul Wheeler

Site Address: 125 North Road HORRUM, Australia 6302

Drawing # TMUN150169 - 3

Print Date: 21/09/15

Layout

Seller: THE SVED COMPANY MANDRANG
 DT Edwards & TG Edwards
 Phone: (08) 6384 5020
 Fax: (08) 9235 0725
 Email: mandrang@thesvedcompany.com.au

SHOWERS ENGINEERING PTY LTD
 ACN 075 007 144
 ME Asst. (Registered NFER Structural & Civil) 321707
 CLD : RP/EC No. : 1547, VAC : EC24162, TAS : CC26001, N.T. : 46028ES.
 Practising Professional Structural & Civil Engineer

Signature: 
 R.J. Showers Date: 21/09/15

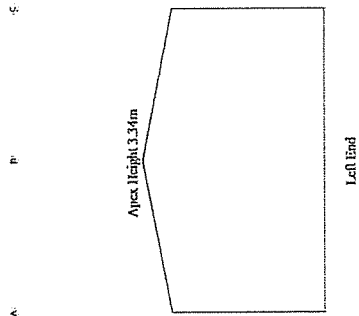
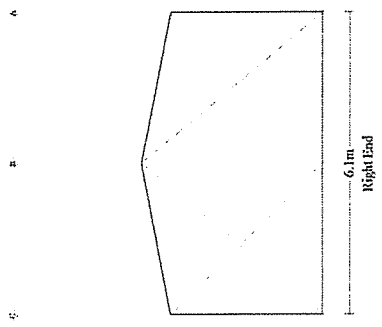
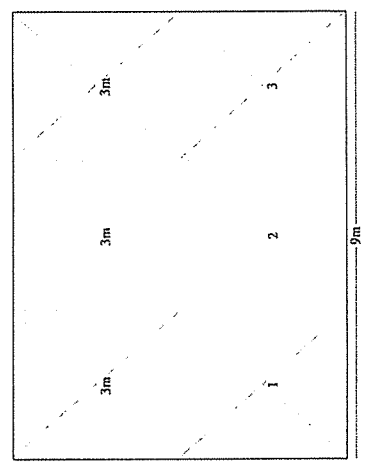
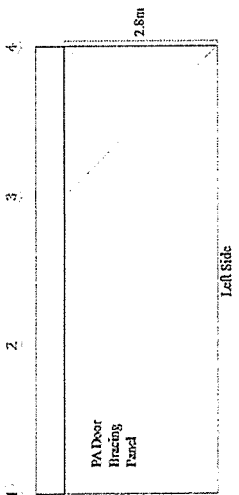

SHOWERS ENGINEERING PTY LTD
ACN 075 007 144
ME Asst. (Registered NFER Structural & Civil) 321787
CLD : RPEQ No. 1547, MC : EC24162, T/S : CC/6004, N.T. : 4692665;
Practising Professional Structural & Civil Engineer

Signature:  R.J. Showers Date: 21/09/15

Seller: THE Shed Company Munding
DT Edwards & TC Edwards
Phone: (08) 6394 5020
Fax: (08) 9285 0725
Email: munding@shedcompany.com.au

Bracing

Purchaser Name: Paul Wheeler

Site Address: 125 North Road YORK WA Australia 6302

Drawing # TMJN150160 - 5

Print Date: 21/09/15